

Project Plan

Floating Decorative Wall Shelf



Estimated Time: 1 **Hour**

Skill/Experience **Beginner**

Overall Dimensions:

Height 22 ¼" x Width 16" x Depth 6"

Materials

- 1 Sheet of Plywood 2 feet x 2 feet - **1 Piece** (Project Panel from big box store if you don't have in hand)
- 1 ½" Construction Screws - **minimum 35 Screws** (Cabinet Screws Recommended)
- General Purpose Wood glue

Tools Needed

- Safety Glasses
- Pencil and tape measure
- Speed Square
- Table saw and Miter saw (optional)
- Drill driver
- Pin Nailer (Optional).

Cut List

Material	Part	Dimensions	Qty
Plywood	Sides	10" x 5 ½"	2
Plywood	Top	10" x 5 ½"	1
Plywood	Bottom	10" x 5 ½"	1
Plywood	Back	22 ¼" x 4"	1
Plywood	Middle/Divider	16 x 5 ½"	1

For Questions Contact - support@woodwordson.com

Instructions

Step 1 – Making the Cuts

Cut the boards according to the cut list above

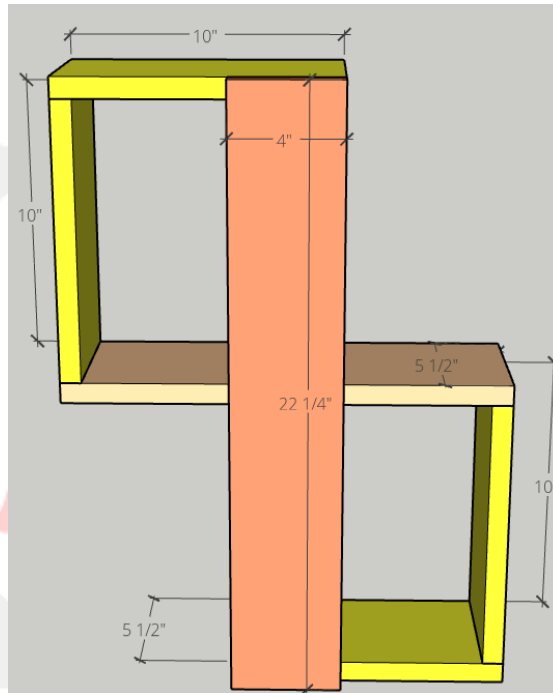

Step 2 – Assembly

Start by attaching the top and the bottom to the back board using some wood glue screws. Two screws for each should be enough.

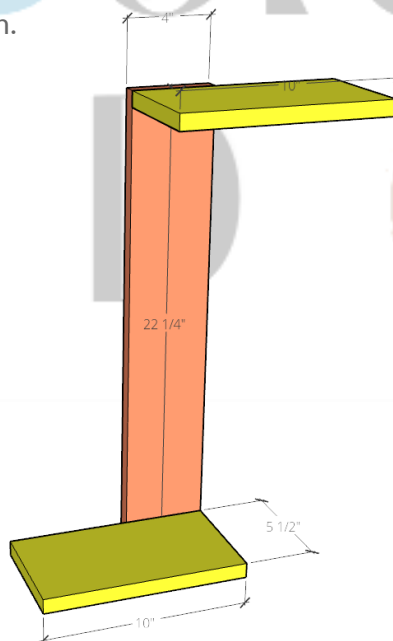

For Questions Contact - support@woodwordson.com

Step 3

Attach the sides to the top and the bottom using wood glue and screws. Two screws on each side should be enough.

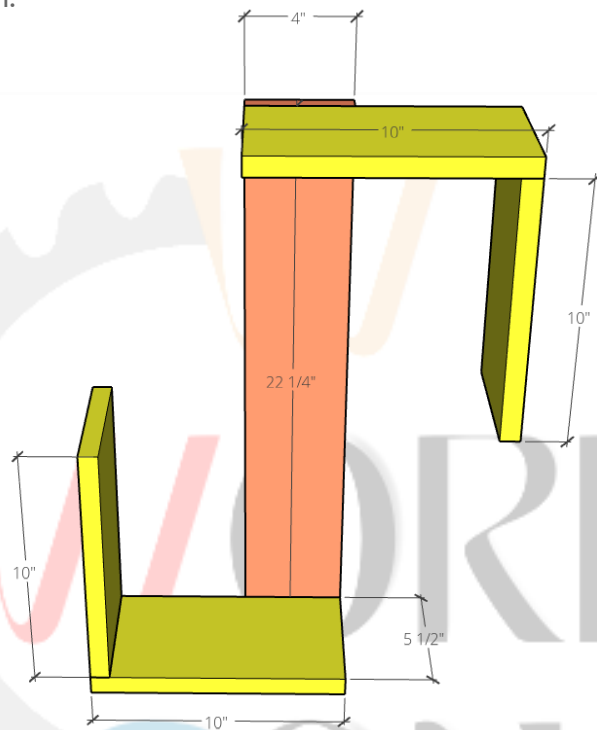

Step 4

Attach the middle dividing piece using wood glue and screws. Two screws to each side and two at the back should be enough.

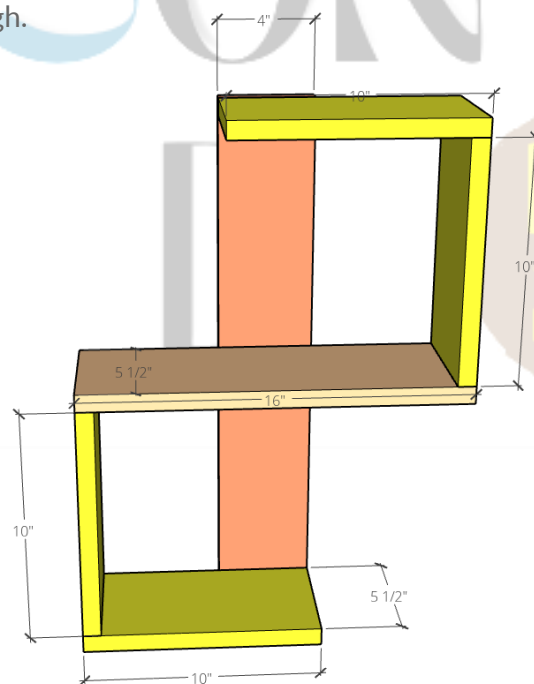

For Questions Contact - support@woodwordson.com

Tips

- Make sure the blade on the saw that you are using is not dull. This will ensure clean cuts on the lumber.
- You can use a twelve-inch squeeze clamp (example shown below) to hold the bottom and side after you apply the wood glue. This will free up your hands so that you can drive the screws to secure the boards together.
- Finishing with stain or paint is optional, but you can definitely sand off any visible splinters sharp edges or rough spots, since that will make for smoother and safer handling.
 - Using a pre-stain will make for a better looking even coat stain
- For more tips. Check out the full video for free here - <https://youtu.be/zulMZ39hR9A>



For Questions Contact - support@woodwordson.com